

# Model: H-AAA650

## ★ Specifications

Nominal Voltage	1.2 V	Final Discharge Voltage	1.0 V
Dimension of Production (with tube)	D(Diameter)	10.5 <sup>+0.0</sup> <sub>-0.7</sub> mm	
	C(Cover)	5.0± 0.2 mm	
	H(Height)	43.8 <sup>+0.0</sup> <sub>-1.0</sub> mm	
Capacity	Nominal	650 mAh (minimum at 0.1C/0.2)	
	Typical	595 mAh (minimum at 0.1C/1C)	
Charging	Standard	0.1C (65mA) for 14~16 hrs	
	High Rate	1C (650 mA) for approx. 1.2 hrs	
Temperature Range for Operation (Humidity: Max 85%)	Standard Charge	0 ~ +45°C	
	Rapid Charge	+10 ~ +45°C	
	Discharge	-20 ~ +60°C	
	Storage	-20 ~ +55°C (less than 1 month)	
-20 ~ +35°C (less than 1 year)			
Internal Impedance at 1000Hz	Approx. 25 mΩ at after charge		
Weight	13.5 g	Service Life	≥ 500 cycles

## ★ Construction

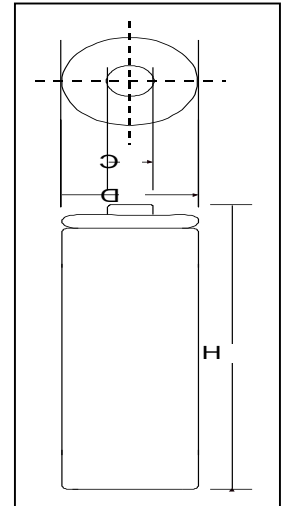

## ★ Typical Characteristics

Typical Discharge Curve(@23°C)

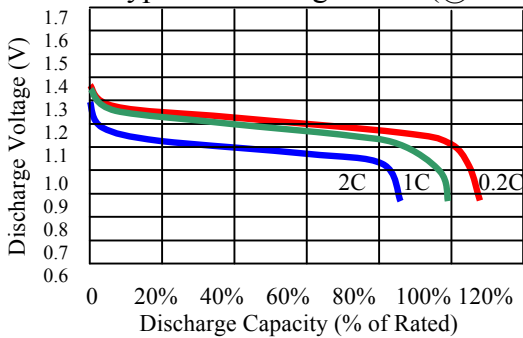

Typical Effect of Discharge Rate on Actual Capacity

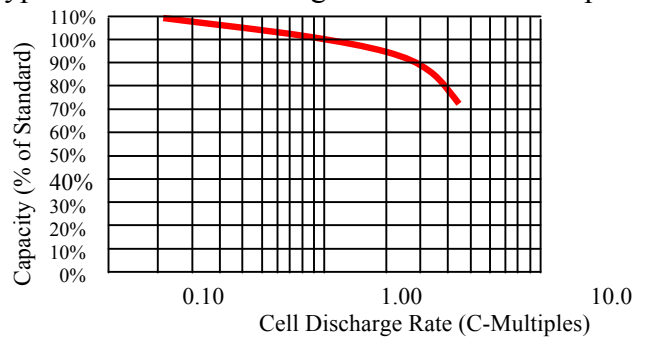

Typical Charge Curve(@ 23°C)

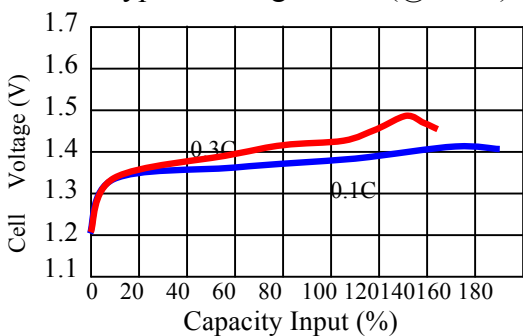

Typical Effect of Discharge Temperature on Actual Capacity

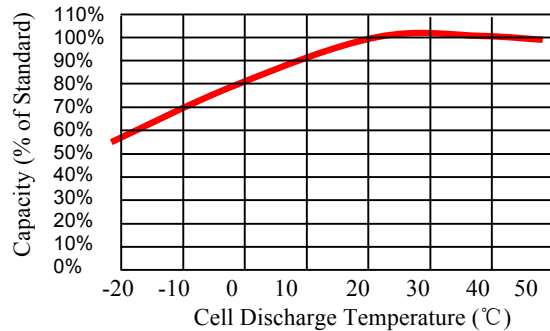

Typical Effect of Cell Discharge Temperature on Voltage-MPV

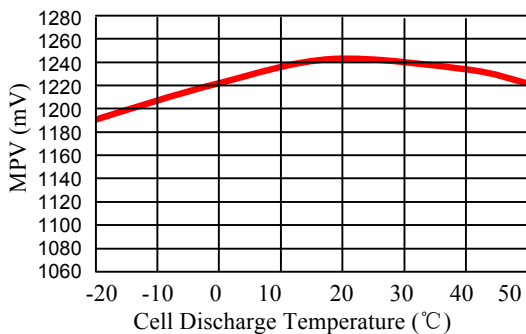

Typical Effect of Cell Charge Temperature on Actual Capacity

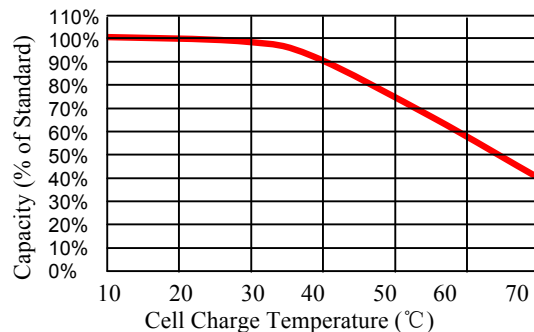

\*Weight , Service Life and Internal Impedance are for reference.