

# Model:H-BC110

## ★Specifications

Nominal Voltage		1.2V	Final Discharge Voltage	1.0V
Nominal Capacity			110mAh (minimum at 0.1C/ 0.2C)	
Dimensions	Diameter		15.2±0.2 (mm)	
	Height		7.7±0.2 (mm)	
Weight Approx.			3.6 g	
Internal Impedance at 1000Hz.			Approx. ≤900 mΩ at after charge	
Charge	Standard		0.1C (11mA) for 14~16 hrs	
	Rapid		0.2C (22mA) for 8 hrs	
	Trickle		0.03C (3.3mA)	
Temperature Range for Operation (Humidity: Max 85%)	Charge	Standard	0~+45°C	
		Rapid	+10~+45°C	
	Discharge		-10~+45°C	
	Storage		-20~+45°C (less than 1 month)	

## ★Dimensions

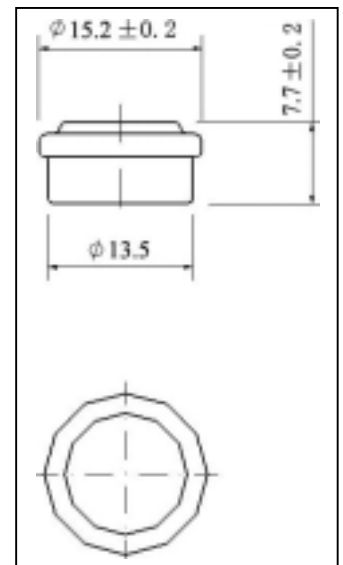

## ★Typical Characteristic

Typical Charge Curve (11mA)

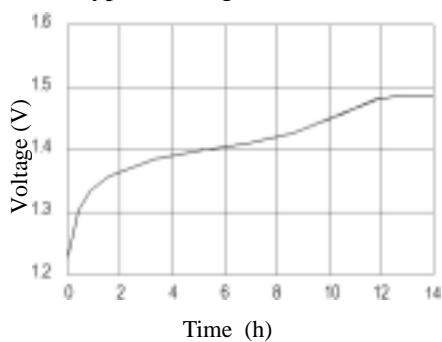

Typical Discharge Curve (22mA)

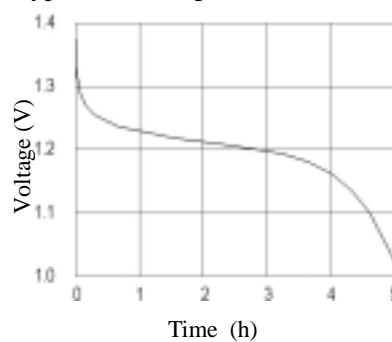

Cycle Life Curve

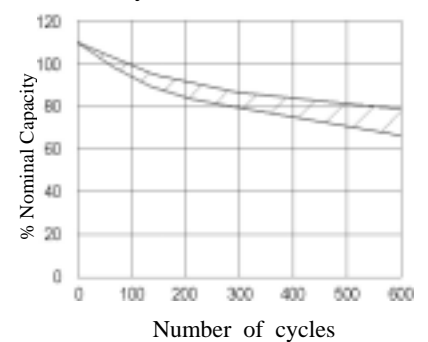

Typical Charge Curve at Various Currents

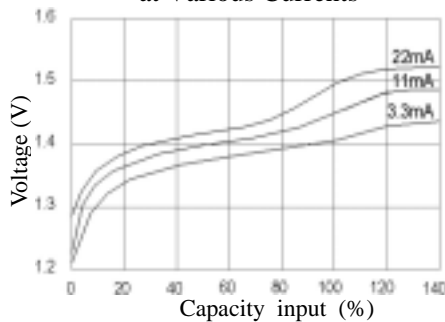

Discharge Curve at Various Temperatures (22mA)

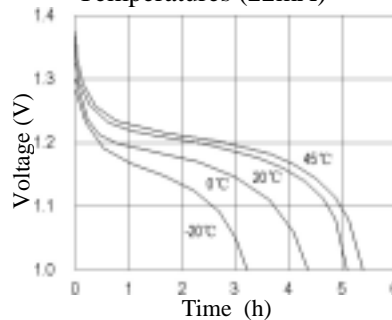

Self-Discharge Rate at Various Temperatures

