

Ni-MH Prismatic Battery Individual Data Sheets

Type: H-P7/5F6 900

Specifications

Nominal voltage		1.2V	
Capacity ¹		0.2C Discharge	1C Discharge
	Minimum	1100mAh ²	990mAh
	Typical ³	1210mAh	1100mAh
Dimensions		mm	inch
	Width	17.0 ⁰ _{-0.5}	0.67 ⁰ _{-0.020}
	Thickness	6.0 ⁰ _{-0.5}	0.24 ⁰ _{-0.020}
	Height	67.0 ⁰ _{-1.0}	2.64 ⁰ _{-0.039}
Weight ⁴		Grams	Ounces
		24.8	0.87
Internal impedance ⁴ at 1000Hz.		30mΩ (After charge)	
Charge	Standard	90mA(0.1C) X 15hrs	
	Rapid	900mA(1C) X 1.2hrs	
Ambient temperature	Charge		°C
		Standard	0°C to 45°C
	Rapid	10°C to 40°C	
	Discharge		°F
		Standard	32°F to 113°F
Storage		50°F to 104°F	
		-20°C to 65°C	-4°F to 149°F
		-20°C to 45°C	-4°F to 113°F

Dimensions(with tube)(mm)

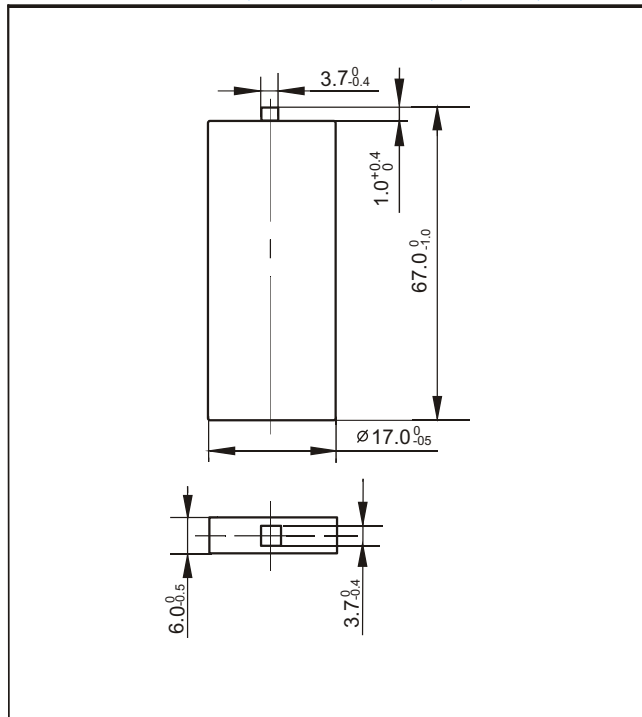

Note:

1. After charging at 0.1C for 15 hours.
2. Nominal capacity, rated at 0.2C, 20°C
3. Average capacity. For reference only.
4. Weight and internal impedance are for reference.

Typical Characteristics

Standard charge characteristics

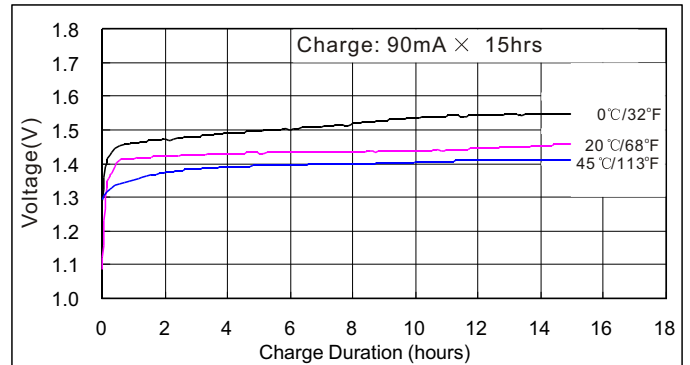

Rapid charge characteristics

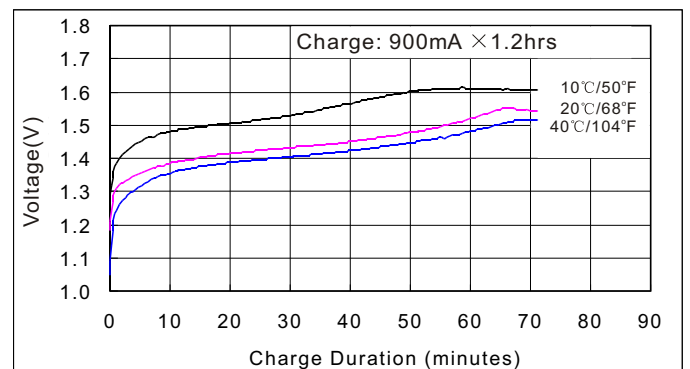

Discharge characteristics at various rate

