

Ni-MH Prismatic Battery Individual Data Sheets

Type: H-P7/5F6 1300

Specifications

Nominal voltage		1.2V		
Capacity ¹		0.2C Discharge	1C Discharge	
	Minimum	1300mAh ²	1170mAh	
	Typical ³	1430mAh	1300mAh	
Dimensions		mm	inch	
	Width	17.0 ⁰ _{-0.5}	0.67 ⁰ _{-0.020}	
	Thickness	6.0 ⁰ _{-0.5}	0.24 ⁰ _{-0.020}	
	Height	67.0 ⁰ _{-1.0}	2.64 ⁰ _{-0.039}	
Weight ⁴		Grams	Ounces	
		25.5	0.899	
Internal impedance ⁴ at 1000Hz.		30mΩ (After charge)		
Charge	Standard	130mA(0.1C) X 15hrs		
	Rapid	1300mA(1C) X 1.2hrs		
Ambient temperature	Charge		°C	°F
		Standard	0°C to 45°C	32°F to 113°F
	Rapid	10°C to 40°C	50°F to 104°F	
	Discharge	-20°C to 65°C	-4°F to 149°F	
	Storage	-20°C to 45°C	-4°F to 113°F	

Dimensions(with tube)(mm)

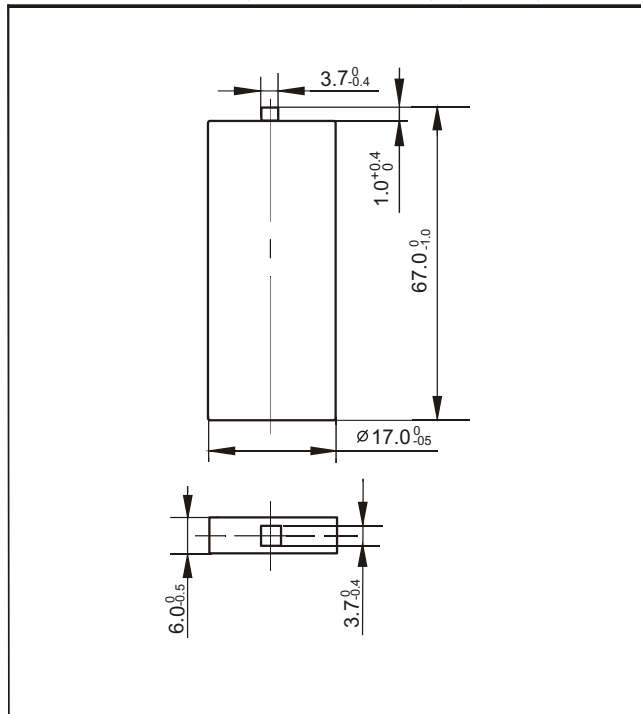

Note:

1. After charging at 0.1C for 15 hours.
2. Nominal capacity, rated at 0.2C, 20°C
3. Average capacity. For reference only.
4. Weight and internal impedance are for reference.

Typical Characteristics

Standard charge characteristics

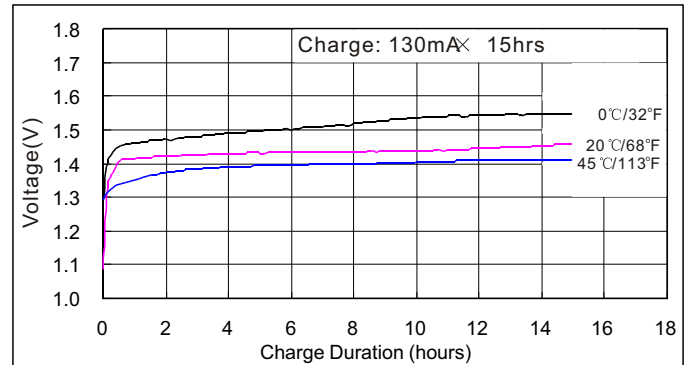

Rapid charge characteristics

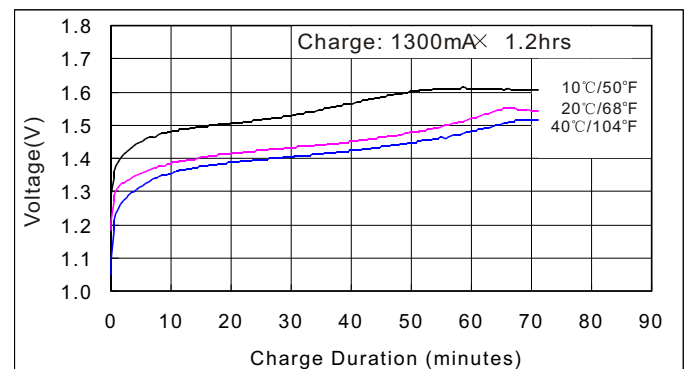

Discharge characteristics at various rate

