

# Li-ion Prismatic Battery Individual Data Sheets

## L-P103450ARH

### Specifications

Nominal Voltage		3.7V	
Capacity <sup>1</sup> (mAh)	0.2C Discharge		
	Minimum	1650mAh <sup>2</sup>	
	Typical <sup>3</sup>	1800mAh	
Dimen- Sions	Thickness	mm	inch
		10.5 <sup>0.5</sup>	0.403 <sup>0.020</sup>
	Width	33.8 <sup>0.5</sup>	1.338 <sup>0.020</sup>
	Height	50.0 <sup>0.6</sup>	1.968 <sup>0.024</sup>
Weight*		Grams	Ounces
		37	1.34
Internal impedance* at 1000Hz		< 70 mΩ (After charge)	
Charge	Standard	900mA(0.5C) × 5hrs	
	Rapid	1800mA(1C) × 2.5hrs	
Ambient temperature	Charge	°C	°F
		0°C to 45°C	32°F to 113°F
	Discharge	-20°C to 60°C	-4°F to 140°F
	Storage	-20°C to 45°C	-4°F to 113°F

### Charge characteristics

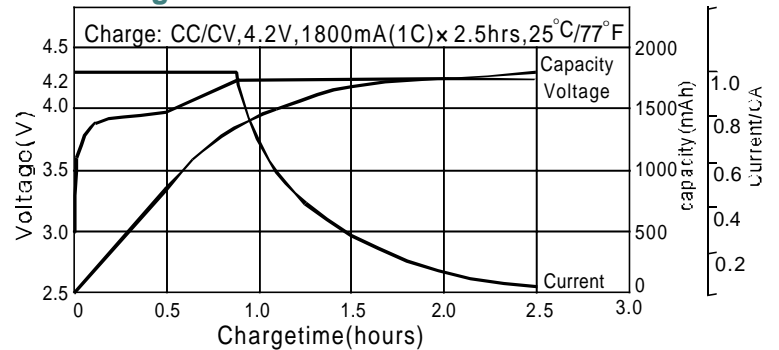

### Discharge temperature characteristics

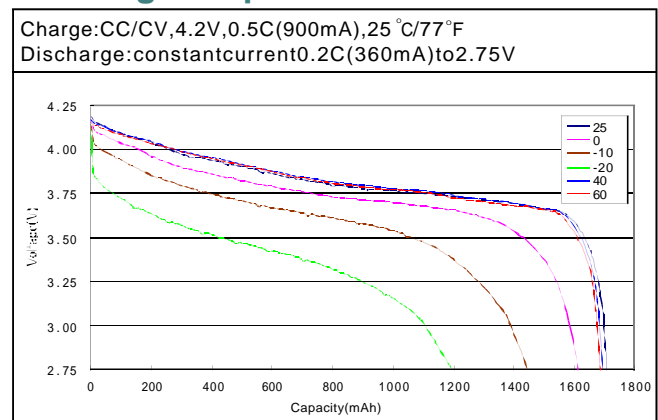

### Discharge rate characteristics

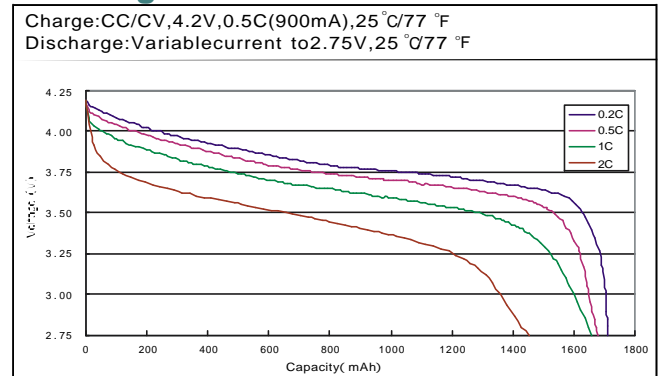

### Cycle life characteristics

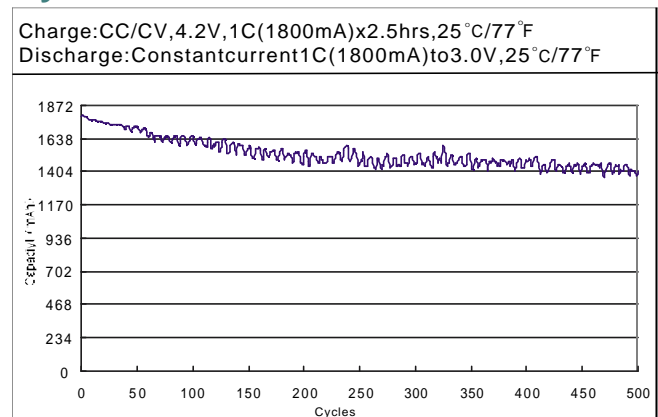

### Dimensions (bare cell)

(mm)

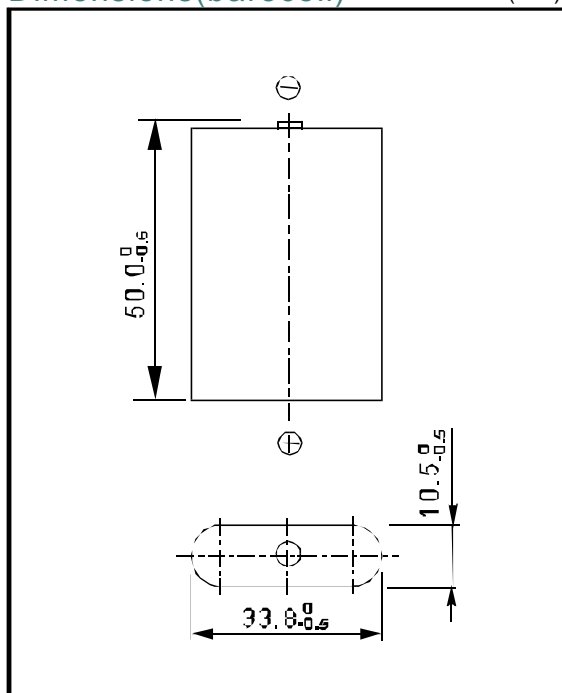

### Note:

1. After charging at 1C for 2.5 hours.
  2. Nominal capacity, rated at 0.2C, 25°C/77°F.
  3. Average capacity. For reference only.
- \*. Weight and internal impedance are for reference.